

thodacon[®] | flexiPLUG

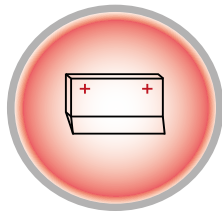

The Flexible Adjustable Wiper



Replaceable

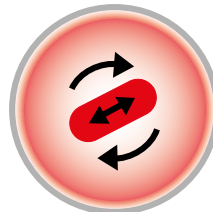

Flexible Adjustable

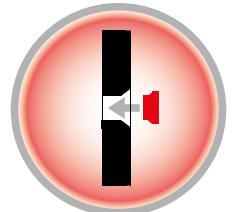

Simple Mounting

flexiPLUG

The Flexible Adjustable Wiper

Present Way Wipers are equipped with long holes to adjust the preload of the wiper lip of Way Wipers in relation to the wiped surface.

This requires a complicated production method, because the long holes need to be milled. This can be solved much easier with thodacon's new flexiPLUG.

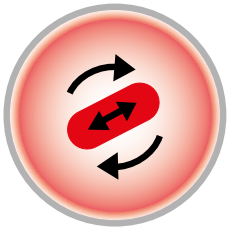

Flexible Adjustable

Thodacon flexiPLUG can be rotated by 360° in its central hole. It can be turned with an ordinary screw driver or with the specially developed Mounting Device (available separately) to put the long hole in the desired angle. The adjustable angle of the long hole is important for wiping of complex surfaces with mitre cuts or example for complicated machine beds of lathes. Because they typically use standard way wiper profiles which are tailored to cover different angles with mitre cuts.

It's also easy to react to high tolerances of sheet metals with adjustable long holes.

FlexiPLUG is easy to use, modular and economical.



thodacon[®]

flexiPLUG

The Flexible Adjustable Wiper

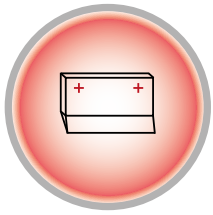

Replaceable

Also existing way wipers with fixing holes can be upgraded to the new flexiPLUG solution, by simply drilling a bigger hole into the existing onem, adding a chamfer with a countersinker and finally attaching the flexiPLUG.

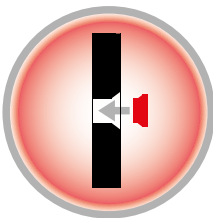

Simple Mounting

Thodacon's flexiPLUG is easy to install. Installation is even possible on site of the machine with simple tools.

Required is a hand drilling machine with corresponding spiral drill and a countersinker.

For installing, simply mark the desired position, (pay attention to the required pre load), drill the hole and finish the operation by adding the chamfer with your countersinker.

After attaching the flexiPLUG the fixation screw can be tightened.

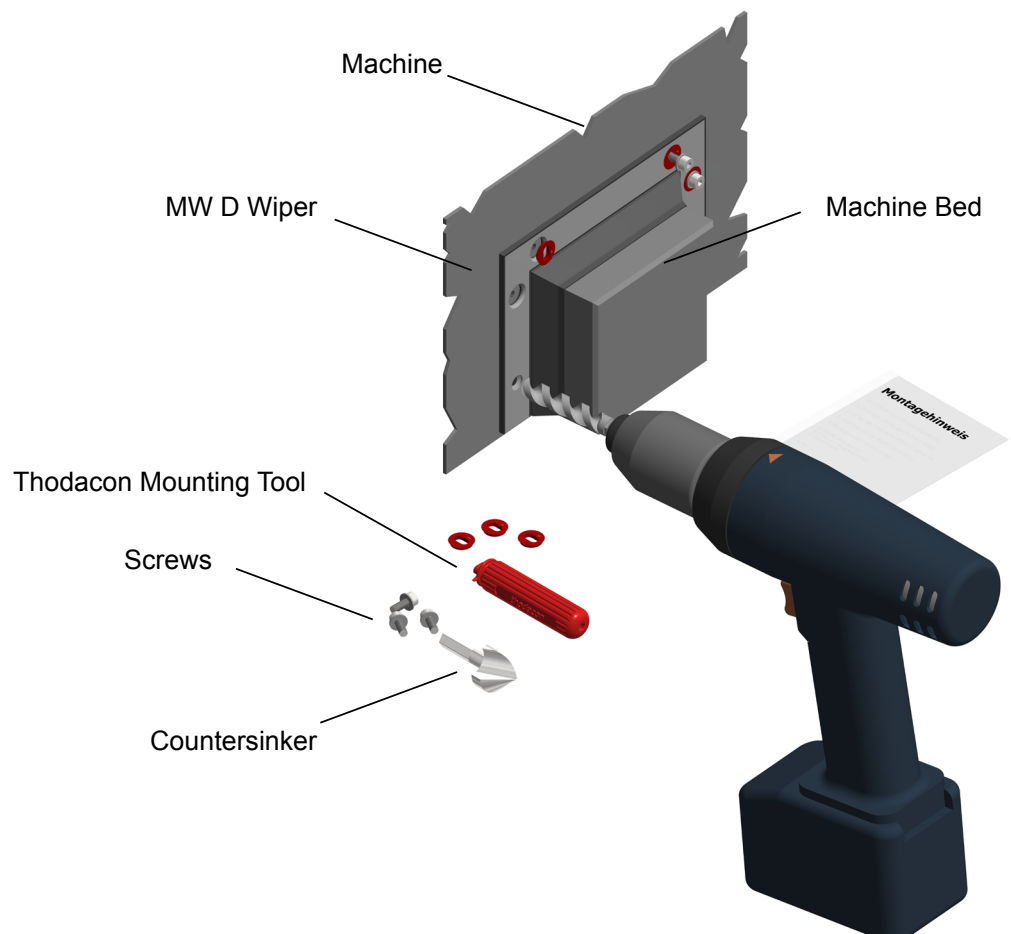

Thodacon Flexiplug is available for all Thodacon Way Wiper Profiles and also for competitor solutions in following sizes:

Technical Information

Type	Order Nr.	Ø D	a	b	t	Material
		[mm]				
TFP M4	1102832	11	4.5	8	2	Stahl
TFP M5	1102833	13	5.5	10	2	Stahl
TFP M6	1102834	15	6.5	12	2	Stahl
TFP M8	1102835	18	8.5	15	2	Stahl

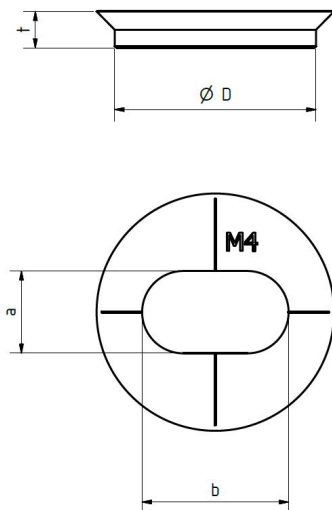

Thodacon Mounting Tool

Type	Order Nr.
TFP Handle	1102836
TFP M4 Tool	1102837
TFP M5 Tool	1102838
TFP M6 Tool	1102839
TFP M8 Tool	1102840

thodacon[®]
www.thodacon.com

thodacon[®]
Thodacon Werkzeugmaschinenenschutz GmbH

Rosenheimer Straße 64a
83059 Kolbermoor, Deutschland
Tel: +49 (0)8031 / 22205 - 71
Email: sales@thodacon.de

thodacon[®]
Machine Tool Protection Co., Ltd.

Lu-Ou-Str. 43, Hu Dai
Wuxi 214161, China
Tel: +86 510 8329 1518
Email: sales@thodacon.cn

Zertifiziert nach
ISO 9001:2008
ISO 14001
ISO 18001